

Water Well Construction Permit Application

Lower Big Blue Natural Resources District

805 Dorsey St. P.O. Box 826 Beatrice, NE 68310

402-228-3402 www.lbbnrd.net

This form must be completed in full and be accompanied by a non-refundable \$50.00 filing fee (payable to the Lower Big Blue Natural Resources District). Please refer to number nine below if this form is being submitted as a late permit.

Please take the time and review the rules of the permit below. Ensure all information is filled out correctly. An incomplete or defective application will be returned by the District, with 60 days being allowed for resubmission. All permits are subject to Board approval within 30 days of a complete application being filed with the District. Applications for replacement wells will be expedited to the extent possible between June 1st and September 1st.

PERMIT RULES AND REGULATIONS

(Per Neb. Stat. 46 and LBBNRD Groundwater Rules & Regulations Rev. September 20, 2022)

1. Any person who intends to construct any new or replacement water well(s), on land which he or she owns or controls within the District shall, before commencing such activity, apply for a permit from the District on forms provided by the District and receive approval from the District (*LBBNRD Ch.5*).
2. All permit applications to construct a new well must be accompanied by a test-hole log to be used in the process of scoring the potential well. Upon approval, a new well may not be constructed more than 300 feet from the test-hole location accompanying the permit application (*LBBNRD Ch. 5.5*).
3. No water well requiring a permit under this chapter shall be constructed within 1,000 feet of any other registered irrigation, public water supply, or commercial/industrial wells under separate ownership or any non-constructed wells with a valid well permit. No water well requiring a permit under this chapter shall be constructed within 500 feet of a well pumping 50 gpm or less under separate ownership. Additionally, no replacement well may be constructed more than 50 feet closer to another high capacity well under separate ownership if the original well is already less than 1,000 feet from a well under separate ownership. However, when replacing a high capacity well, the state requirement of 600 feet between high-capacity wells of separate ownership must still be maintained. Illegal wells are not protected (*LBBNRD Ch. 5.3*).
4. Water wells may not be drilled within 50 feet of a stream bank without first getting a surface water right for that stream from the Nebraska Department of Natural Resources (NDNR) pursuant to Neb. Stat. 46-637.
5. Permits are not required for test holes, temporary dewatering wells with an intended use of less than 90 days, or water wells designed and constructed to pump (yield) 50 gallons per minute or less (*LBBNRD Ch. 5.11*).
6. This permit does not register the water well with the NDNR. Neb. Stat. 46-602 requires all water wells, even if the wells are commingled, to be registered with the NDNR within 60 days after the water well is completed.
7. The issuance by the District of this permit or registration of a water well by the director of the NDNR pursuant to Neb. Stat. 46-602 shall not vest in any person the right to violate any rule, regulation, or control in effect on the date of issuance of the permit or the registration of the water well or to violate any rule, regulation, or control properly adopted after such date.
8. If the water well is not constructed and equipped within a one-year period from the date of approval under the terms of the approved permit, the District will cancel the permit, and a new water well permit application is required (*LBBNRD Ch. 5.13*).
9. A person who has failed to obtain a permit as required shall make application for a late permit. A late permit may be issued when a water well was illegally constructed or modified without first receiving a permit. Late permits shall be accompanied by a non-refundable \$1,000.00 fee payable to the District and shall be subject to Board approval (*LBBNRD Ch.5.2.3*).
10. Any person who, on or after February 3, 1997, commences or causes construction of such a water well for which the required permit has not been obtained, or who knowingly furnishes false information regarding such permit, shall be guilty of a Class IV misdemeanor pursuant to Neb. Stat. 46-602.01 and 46-613.02, and subject to a cease-and-desist
11. Flowmeters will be required prior to the withdrawal of groundwater on all new and replacement water wells designed and constructed to pump greater than 50 gallons per minute.

Date Received: _____ Permit Number: _____ Reg. No. _____

Date Approved: _____ Date Denied: _____

This permit expires one (1) year from the approval date. NRD Representative: _____

1. APPLICANT:

Name: _____

Address: _____ Phone: _____

2. PURPOSE FOR PERMIT APPLICATION:

- New Irrigation Well Replacement Irrigation Well
- Public Water Supply/Municipal Well Dewatering Well (more than 90 days) Late Permit Application (see #9 on front)
- Other (please specify): _____

3. LOCATION OF THE PROPOSED WELL:

Subsection: _____, Section: _____, TWN/RNG: _____

Feet from NORTH/SOUTH section line: _____

Feet from EAST/WEST section line: _____

County: _____

PLEASE MARK LOCATION AND WATER USE AREA ON THE MAP

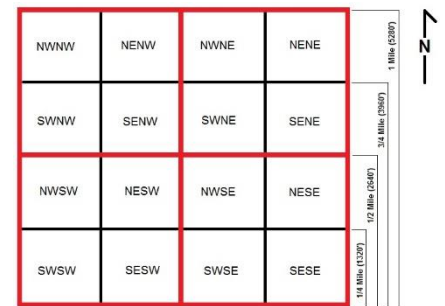

4. REPLACEMENT WELLS:

Registration number of original well: _____

Subsection: _____, Section: _____, TWN/RNG: _____

Feet from NORTH/SOUTH section line: _____

Feet from EAST/WEST section line: _____ County: _____

Date original well was last operated: _____

Date original well was or will be decommissioned: _____

Distance of original well from the proposed replacement: _____

Acres irrigated by original well: _____

5. NEW/REPLACEMENT WELL INFORMATION:

Acres to be irrigated: _____ (Irrigated acres are required to be certified with the LBBNRD)

Flow Meter Brand: _____ Model: _____

Type of irrigation: Gravity Pivot Sub-Drip Other (please specify): _____

Will this well be used in a system with other wells? Yes No How many wells will be used in the system? _____

See LBBNRD Groundwater Rules & Regulations 5.13 - 5.13.4 for commingled wells. A Site Plan is required for Livestock Feeding Operations. Upon approval, all constructed wells must be registered (see #6 on page 1 of this application).

6. WELL AND PUMP INFORMATION:

Approximate date of construction: _____

Estimated total well depth: _____ Estimated pumping capacity: _____

Pump column diameter: _____ Casing diameter: _____

Test-hole log attached if applicable: Yes No

Name of well driller: _____

7. I certify that I am familiar with the information contained on page 1 and 2 of this application and all rules and regulations pertaining to water wells in the State of Nebraska and the Lower Big Blue NRD Groundwater Quantity Rules and Regulations and that such information provided on this application is, to the best of my knowledge, true, complete, and accurate.

Signature of Applicant: _____

Date: _____