

**DEVELOP**

Dynamic balance

[www.develop.eu](http://www.develop.eu)



**ineo i-SERIES**  
is at the heart  
of your business

# Tomorrow's workplace today

## Introducing the ineo i-Series from DEVELOP

Born from our desire to rethink the role of multifunctional devices in business, our next generation technology sits at the heart of your connected environment. Simply and securely bringing together people, places and devices to change the way you work.

### The workplace is changing

- As more tasks move towards individual work in a place of the individual's choice, central offices are becoming hubs for communication.
- As office documents become more digitized and the volume of data increases, centralized management and better access to documents is vital.
- As business data leaks and hacking become more commonplace, the need for security is increasingly critical.

### ineo i-Series is the solution

- With simple operability and high-quality performance, ineo i-Series allows people to complete tasks efficiently and effectively from anywhere.
- With next generation security technology built in, ineo i-Series provides a reliably safe environment for your business.



# i-Series is simple and secure

**We've simplified, secured and enhanced what technology can do for your business.**

## **Key benefits**

- › Stay in control of your information
- › Protect your data and stop virus threats
- › Security visibility, implementation and continuity
- › The peace of mind to focus on core activities

## **Intelligent simplicity**

With a large touchscreen operation panel, smartphone style user interface and voice control, the ineo i-Series is intelligently simple.

## **Next generation security**

The next generation ineo i-Series comes with the highest security standards built in. The i-Series is ready for General Data Protection Regulation (GDPR), with remote backup and endpoint security.

With our ineo SECURE services, we tailor the security settings to your needs, so your data is fully protected. And the integrated anti-virus software ensures no virus can harm your business.



# i-Series is intuitive

Inspired by the way people interact with technology, we've completely redesigned the user experience.



## Designed for people

The stylish new ineo i-Series looks at home in today's office environment, with contemporary touches like a floating operation panel, rounded edges and LED status indicators.

With a 24° to 90° tilt angle, the large 10.1" tablet style touch panel provides convenient operation for all users, especially those in a wheelchair.

## Putting users first

The new ineo i-Series offers a market leading and intuitive smartphone style experience.

In fact, the user experience is so familiar there's practically no learning curve and users can customize their screen in the same way as their mobile device.

In the new card-type Quick Copy screen, all main setting options are directly visible without scrolling or searching. Users can apply their desired settings with fewer clicks and pop-ups, making operation faster and more productive. You can also customize your personal home screen by simply adding or removing function icons. Widgets are supported as well, similar to Widgets on Android-based smartphones. This facilitates embedding functionality delivered by Apps into the home screen.



### The waiting is over

The new ineo i-Series is our fastest ever range, boosting workflow and cutting out waiting time. In fact, thanks to its brand new 4 Core CPU, it's four times quicker than our previous ineo+ 368 model.

The new controller integrates all processes and distributes tasks more effectively within the Central Processing Unit. As a result, the user experience is smoother and quicker and there is no waiting time while operating the ineo i-Series.

With the new media sensor, paper weight detection is automatic, and the correct settings are reliably applied every time. Enhancing user convenience, this avoids setting mistakes and minimizes paper jams.

### Connect with voice

For easier operation and enhanced accessibility, users can also operate the ineo i-Series with their voice and even learn from it, in the same familiar way as on their smartphone. It also gives access to blind people, who can autonomously handle their copy and scan jobs, without touching the device.



# store+ find

## Simplify your document management

In many small to mid-sized companies (SMEs) documents and information still end up in storage boxes, files or cupboards. That takes up lots of space and is not very efficient. Electronic document management systems (DMS), however, have often been too expensive or complex to be worthwhile for SMEs. store+find, in contrast, is an easy-to-use and reasonably priced DMS specially designed for SMEs.

### Customised document management

Can you always find the document you want? Do you always know where you've stored information? In many offices documents are either kept in cupboards or stored digitally in network repositories. But to access them easily and quickly you need to know where exactly they are located. store+find puts an end to time-wasting document searches. Just enter what you're searching for and store+find will deliver the required documents. When you're storing documents, the ineo display will guide you through the process. What's more, a self-explanatory user interface does away with the need for time-intensive training sessions. And if you're on the go, you can even access store+find via your smartphone, tablet or notebook. store+find saves you time and space and helps you answer customer enquiries faster. So you save lots of time and can concentrate on your core business.

### Key features

- Archiving of scanned documents or those already stored electronically
- Processing in various formats, e.g. .doc, .xls, .ppt, .pdf or .tif
- Import of e-mails and e-mail attachments straight from Microsoft Outlook
- Easy tagging and document indexing
- Full-text search within a document (OCR recognition)
- Search for saved documents via web browser or client programme
- Follow-up options for documents and e-mails requiring further processing
- Automatic versioning of modified documents
- Key word and index term entry and selection of final scan destination at a ineo multifunctional display before scanning
- Direct access to store+find via a smartphone or tablet to search, preview, send via e-mail, print and store documents

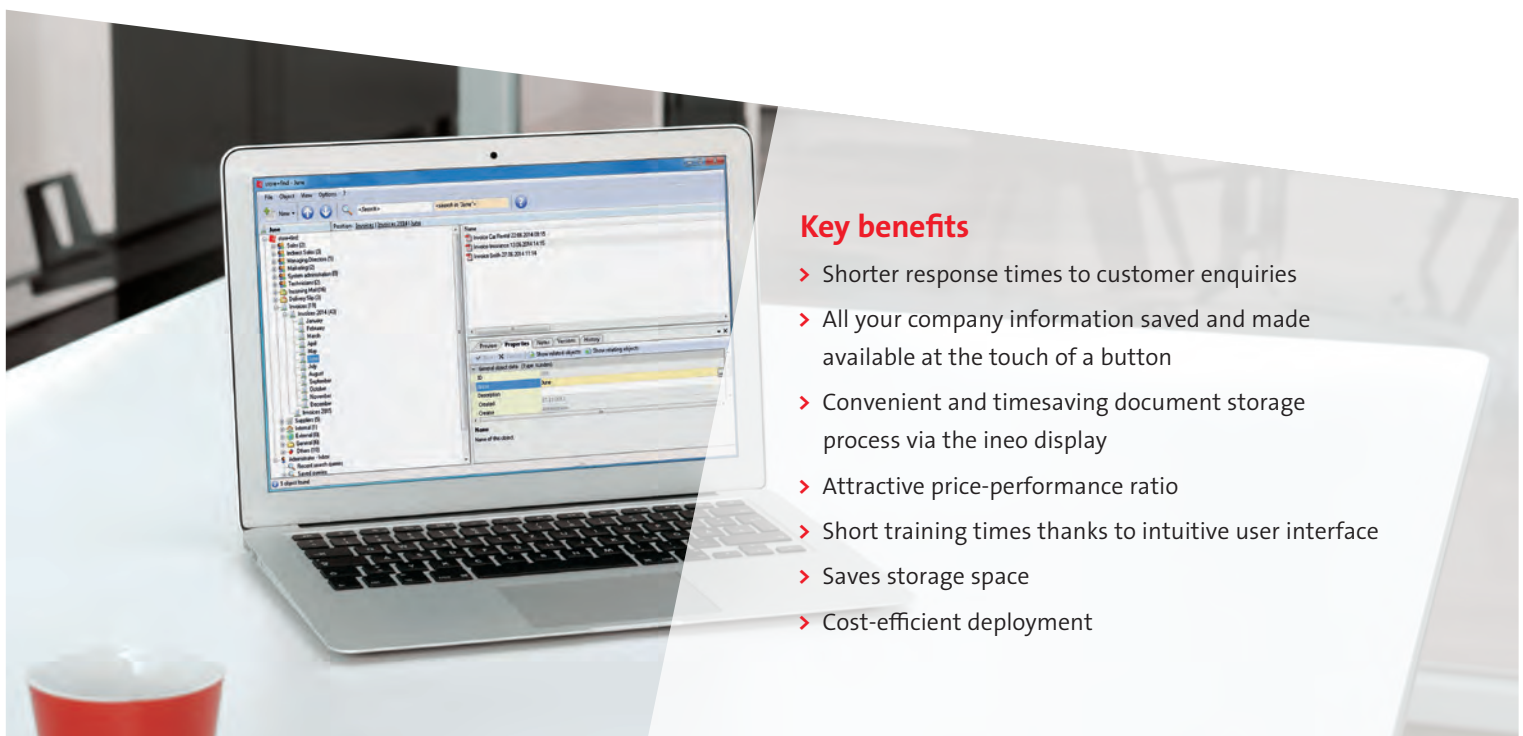

### Key benefits

- > Shorter response times to customer enquiries
- > All your company information saved and made available at the touch of a button
- > Convenient and timesaving document storage process via the ineo display
- > Attractive price-performance ratio
- > Short training times thanks to intuitive user interface
- > Saves storage space
- > Cost-efficient deployment

# convert +share

## Optimise your document workflows

Though automation is standard practice in manufacturing industry, its advantages are yet to be experienced in many offices. Processing documents by hand, in contrast, costs time and money, and can easily lead to mistakes – things small to mid-sized businesses cannot afford. Develop's easy-to use convert+share app helps to do away with manual work and sustainably optimise document workflows – with minimal effort. Workflow optimisation has never been easier.

### Functional highlights

#### Document capturing

- Document processes start directly at the multifunctional printer
- Predefined hot folder automatically forwards incoming documents to convert+share
- PC Client and Printer Client let dedicated users to start their workflows directly from their PCs

#### Document processing

- Creates searchable PDF and PDF/A files
- Scan-to-Word and Scan-to-Excel function
- Zone OCR recognizes textual content within predefined zones of a document
- Barcode reader recognises pre-defined barcode values for further processing or separates multiple documents scanned in a single scan process
- OMR allows processing of questionnaires and the extraction of the results
- Forms Recognition detects documents according to their layout and starts directly the right process without the need of further manual interaction

#### Document transfer

- Stores documents in Microsoft SharePoint, SharePoint Online (Office 365), Evernote, Google Drive, Telekom Cloud, Windows file system, and many more
- Forwards documents to an e-mail server for e-mail transmission
- Sends documents directly to Develop's electronic document management system store+find

#### User management

- Access restriction requires Windows or Active Directory user name and passwords

### Key benefits

- > Capture documents direct from a multi-functional device
- > Process and edit documents as required
- > Transfer documents to any cloud-based archiving system
- > Manage document access through authorisation based on user name and password

# i-Series is safer

**Always safe. Always in control.**

Having complete protection against virus threats gives you the peace of mind to focus on other tasks. So to protect your data, the optional Bitdefender® anti-virus engine automatically scans all transmitted and received data – in real time. You can also run on-demand or scheduled scanning of your data, to make sure you stay protected.

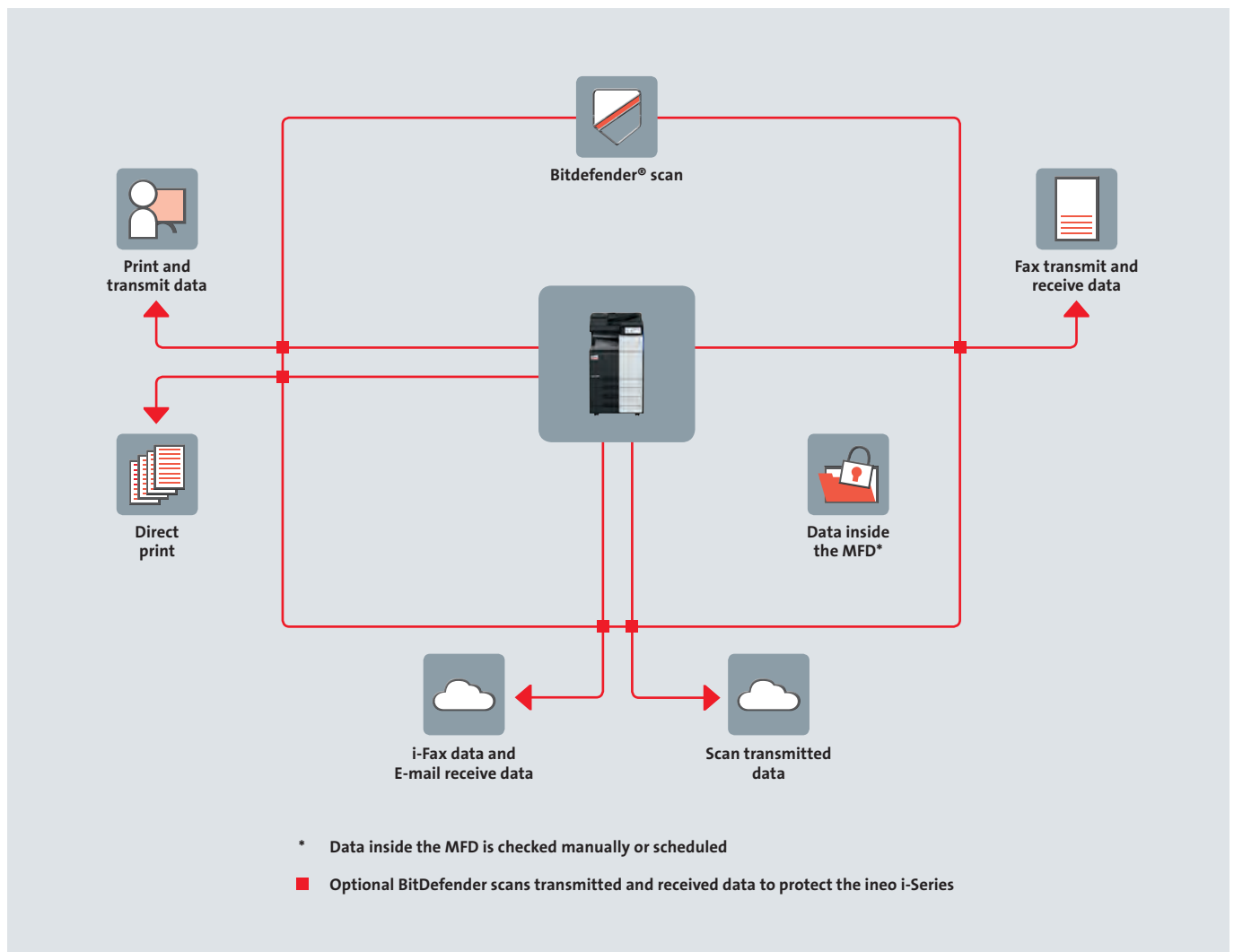





75% OF COMPANIES SAID THEY HAD EXPERIENCED DISASTER RECOVERY FAILURES, RESULTING IN THE LOSS OF CRITICAL APPLICATIONS AND FILES. YET 60% DON'T HAVE A FULL-SCALE DATA RECOVERY PLAN.

Sources: Disaster Preparedness Council, FEMA

# Total care by ineo SECURE

With ineo SECURE services, we've made sure your business is fully protected by providing security tailored to your needs. Continuous security gives you one less thing to worry about. And because our team configures everything for you, you'll save time too.

## Safe and SECURE

- **ineo SECURE** protects the data inside the memory of your ineo i-Series
- **ineo SECURE** protects your ineo i-Series from attacks via encryption
- **ineo SECURE Platinum** secures your devices' network settings
- **ineo SECURE Platinum** secures your ineo i-Series against unauthorized access
- **ineo SECURE Ultimate** provides evidence of all activities and processed information, ensuring a security relevant audit trail
- **ineo SECURE Ultimate's** Bitdefender® anti-virus engine defends you from the threat of viruses
- **ineo SECURE Notifier App** ensures the right settings are implemented and remain unchanged

# ineo i-Series is smarter

## Reduced downtime. All the time.

**Our Worldwide Remote Service Platform** provides a trouble-free experience and minimum downtime.

To ensure continuous and full use, ineo i-Series intelligently collects data for self-diagnostic and remote maintenance and even predicts the optimum replacement time for parts and consumables.

It also uploads the latest firmware, in real or scheduled time. So users know they're always working with up-to-date technology.

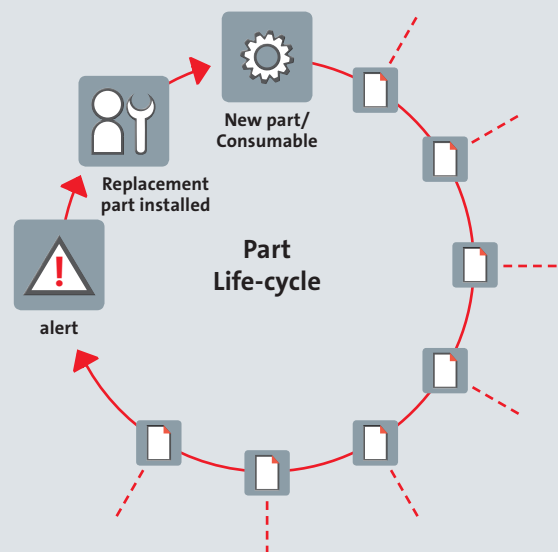

 Data collected for part/consumable replacement predictions



## Industry leading environmental performance

**We have invested substantial resources to keep the environmental impact of the ineo i-Series as low as possible.**

Our new eco settings, low temperature fusing toner and weight detection sensor combine to significantly reduce the consumption of energy and paper.

We're also committed to minimizing waste throughout the product's lifecycle. While our improved consumables and parts use fewer materials and enjoy a longer life, our industry leading air-form packaging solution ensures safe transportation while reducing waste by 20%.



ineo i-Series + 4050i



ineo i-Series + 360i



ineo i-Series + 650i

## ineo i-Series is available now

With intelligent usability, next generation security and seamless connectivity, ineo i-Series brings together people, places and devices to change the way you work.

ineo i-Series is tomorrow's workplace today.



Smythe Business Machines

6 Harbour Court

Belfast, BT3 9HB

t: 028 9020 7000

f: 028 9020 7001

e: [info@sbmonline.co.uk](mailto:info@sbmonline.co.uk)

**DEVELOP**