

# Rotating Vane Flow Indicator for Liquids



measuring  
•  
monitoring  
•  
analyzing

DIG



- Range: 0.13...3.2 GPM to 0.79...21 GPM (Water)
- Connection: 1/8" ...1" NPT
- Housing: Brass, Stainless Steel, or Polypropylene
- $p_{max}$ : 230 PSI
- $t_{max}$ : 176 °F
- $\Delta P$  at Max. Flow: 14.5 PSI



KOBOLD companies worldwide:

ARGENTINA, AUSTRALIA, AUSTRIA, BELGIUM, BULGARIA, CANADA, CHILE, CHINA, COLOMBIA, CZECH REPUBLIC, EGYPT, FRANCE, GERMANY, HUNGARY, INDIA, INDONESIA, ITALY, MALAYSIA, MEXICO, NETHERLANDS, PERU, POLAND, REPUBLIC OF KOREA, ROMANIA, SINGAPORE, SPAIN, SWITZERLAND, TAIWAN, THAILAND, TUNISIA, TURKEY, UNITED KINGDOM, USA, VIETNAM

KOBOLD Instruments, Inc.  
1801 Parkway View Drive  
Pittsburgh, PA 15205  
☎ Main Office:  
1.412.788.2830  
☎ 1.412.788.4890  
info@koboldusa.com  
www.koboldusa.com



## Rotating Vane Flow Indicator Model DIG

### Key Features

- Range: 0.13...3.2 GPM to 0.79...21 (GPM Water)
- Connection: 1/8" ...1" NPT
- Housing: Brass, Stainless Steel, or PP
- $p_{max}$ : 230 PSI
- $t_{max}$ : 176 °F
- $\Delta P$  at Max. Flow: 14.5 PSI



### Material Combination

|            | DIG-11...     | DIG-14...     | DIG-18...     |
|------------|---------------|---------------|---------------|
| Housing    | Brass         | SS (1.3955)   | Polypropylene |
| Cover      | Polysulfone   | Polysulfone   | Polysulfone   |
| Seal       | NBR           | FKM           | NBR           |
| Vane Wheel | Polypropylene | Polypropylene | Polypropylene |
| Axle       | Ceramic       | Ceramic       | Ceramic       |
| $p_{max}$  | 230 PSI       | 230 PSI       | 100 PSI       |
| $t_{max}$  | 176 °F        | 176 °F        | 176 °F        |

### Dimensions (in mm)

DIG-1...N06, DIG-1...N08, DIG-1...N15

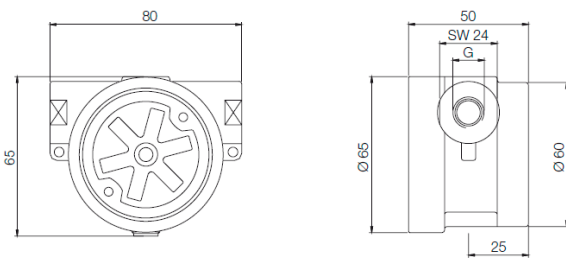

DIG-1...N20, DIG-1...N25

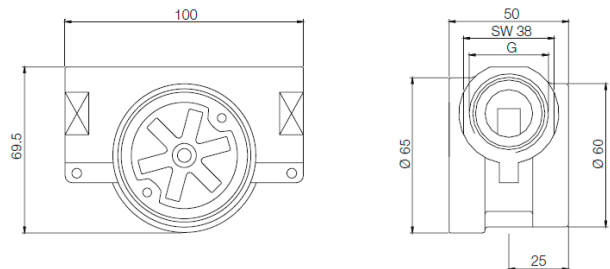

### Order Details (Example: DIG-1435G N25)

| Range (GPM Water) | Model Number |             |             | Connection       |
|-------------------|--------------|-------------|-------------|------------------|
| 0.13...3.2        | DIG-1105G..  | DIG-1405G.. | DIG-1805G.. | ..N06 = 1/8" NPT |
| 0.26...6.6        | DIG-1110G..  | DIG-1410G.. | DIG-1810G.. | ..N08 = 1/4" NPT |
| 0.53...12         | DIG-1120G..  | DIG-1420G.. | DIG-1820G.. | ..N15 = 1/2" NPT |
| 0.53...13         | DIG-1130G..  | DIG-1430G.. | DIG-1830G.. | ..N20 = 3/4" NPT |
| 0.79...21         | DIG-1135G..  | DIG-1435G.. | DIG-1835G.. | ..N25 = 1" NPT   |

\*At max. flow