

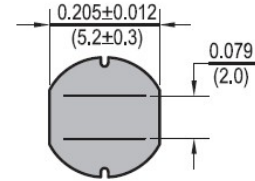

Power Flat Inductor PF0501

Dimensions: $\frac{\text{Inches}}{\text{(mm)}}$

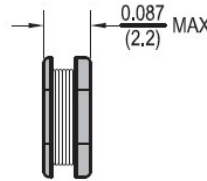
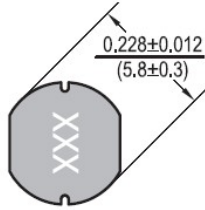
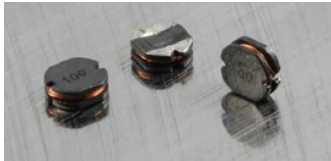

Wilco Part Number	Inductance (uh)	Tolerance (%)	Test Freq. 1V	DCR Max	IDC (mAmps)
PF0501-1R0M-LF	1	20	7.96 Mhz	0.034	4000
PF0501-2R2M-LF	2.2	20	7.96 Mhz	0.064	2650
PF0501-3R3M-LF	3.3	20	7.96 Mhz	0.097	2110
PF0501-4R7M-LF	4.7	20	7.96 Mhz	0.134	1800
PF0501-6R8M-LF	6.8	20	7.96 Mhz	0.187	1500
PF0501-8R2M-LF	8.2	20	7.96 Mhz	0.225	1300
PF0501-100M-LF	10	20	2.52 Mhz	0.255	1100
PF0501-150M-LF	15	20	2.52 Mhz	0.360	1000
PF0501-220M-LF	22	20	2.52 Mhz	0.492	900
PF0501-270M-LF	27	20	2.52 Mhz	0.603	770
PF0501-330K-LF	33	10	2.52 Mhz	0.796	680
PF0501-390K-LF	39	10	2.52 Mhz	0.897	670
PF0501-470K-LF	47	10	2.52 Mhz	1.02	660
PF0501-560K-LF	56	10	2.52 Mhz	1.164	500
PF0501-680K-LF	68	10	2.52 Mhz	1.22	470
PF0501-820K-LF	82	10	2.52 Mhz	1.57	450
PF0501-101K-LF	100	10	1.0 Khz	1.8	360
PF0501-151K-LF	150	10	1.0 Khz	2.8	270
PF0501-221K-LF	220	10	1.0 Khz	4.4	220
PF0501-271K-LF	270	10	1.0 Khz	6.4	190
PF0501-331K-LF	330	10	1.0 Khz	7.2	160
PF0501-391K-LF	390	10	1.0 Khz	8.4	150
PF0501-561K-LF	560	10	1.0 Khz	13.0	130
PF0501-681K-LF	680	10	1.0 Khz	17.0	120
PF0501-821K-LF	820	10	1.0 Khz	19.0	63
PF0501-102K-LF	1000	10	1.0 Khz	24.0	45

Features: Unshielded SMD design, high current applications, ideal for DC-DC converter applications, great for auto insertion.

Physical: packaging 2000 pieces per 13 inch reel, marking EIA inductance code

Electrical: operating temp. -40C to 85C, rated current inductance drop 10% typical

Resistance to Soldering Heat: pre-heat 150C 1 min solder temp. 260C +/- 5C immersion time 10 sec +/- 1 sec solder composition Sn/Ag3.0/Cu0.5

Wilco Corporation 5352 West 79th Street Indianapolis IN 46268
 800-611-2343 Fax 317-228-9340 wilcosales@wilcocorp.com
www.wilcocorp.com