

## Magnafold Shower Door Installation Instructions

showersolutionsusa@sentco.net  
www.showersolutionsusa.com

MF (Standard Soft Panel)  
MFE (Elite Hard Panel)

Model Number \_\_\_\_\_  
Opening Width/Height \_\_\_\_\_  
Date of Purchase \_\_\_\_\_  
S.O. Number \_\_\_\_\_

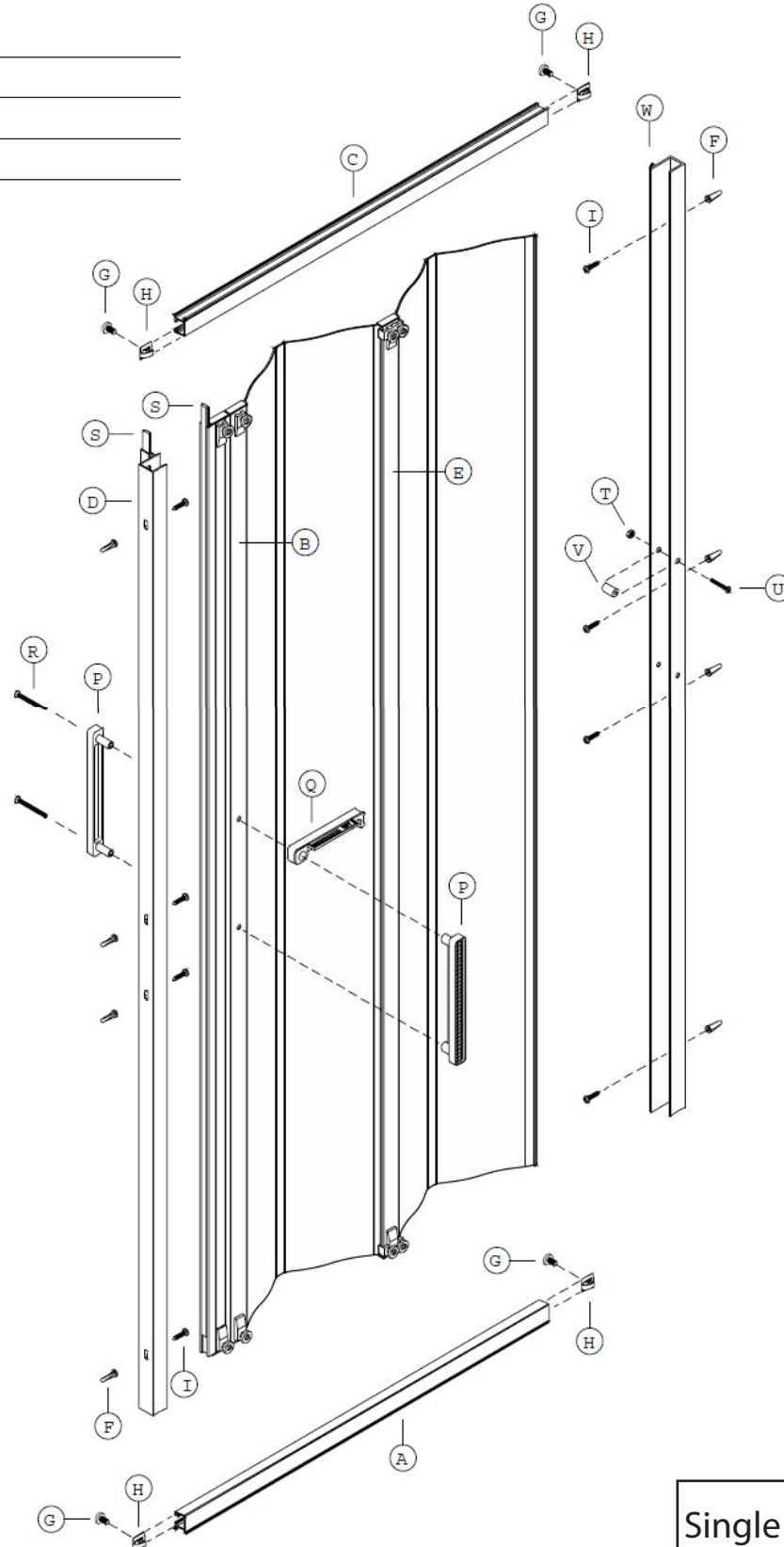

Single Side Opening

### STEP 1:

Begin by laying the entire contents of the unit on the floor to understand the design concept of the product. Note that top and bottom tracks (C&A) are identical in appearance and length and therefore are interchangeable at this point. (see note in step 2)

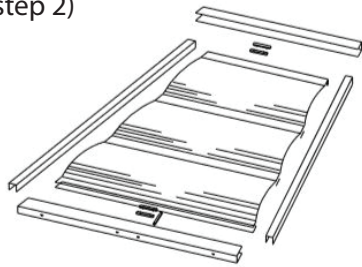

### STEP 2:

Measure the opening width at tub level as shown. Cut Bottom Track (A) to 1/4" less than the measurement obtained and remove all burrs. **Note: Once metal is cut, top and bottom tracks must be treated as separate, non-interchangeable pieces.** Clean track of all metal shavings and lubricate the track's roller groove with petroleum jelly or silicone grease. Temporarily place the Bottom Track (A) in the center of the shower threshold as shown in step 3 (note that track opening is the the inside) Use tape to temporarily hold Bottom Track in place.

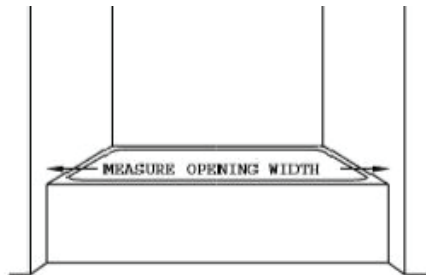

### STEP 3:

Determine which side of the door you want to open and set the Wall Jamba with magnetic strip (D) over the end of the Bottom Track on that side of the opening (as shown below). Set the Wall Jamba with panel receiver (W) on the other end of the Bottom Track. Plumb the Wall Jamb, then pencil mark the shower walls through each installation hole and the side of the Wall Jamb at top and bottom. Remove Wall Jamb and Bottom Track. Using a 1/4" bit, drill 1" deep installation holes in the locations marked and insert Plastic Screw Anchors (F).

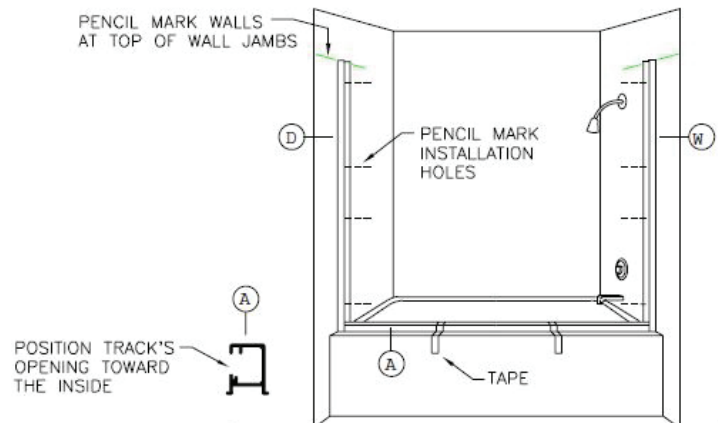

### STEP 4:

Measure the opening width at the top of the Wall jambs (indicated by top pencil marks). Cut Top Track (C) to 1/4" less than the measurement obtained and remove all burrs. Clean track of all metal shavings and lubricate the track's roller groove with petroleum jelly or silicone grease. **Note: Lubrication of top and bottom roller grooves is of the utmost importance and should not be ignored.**

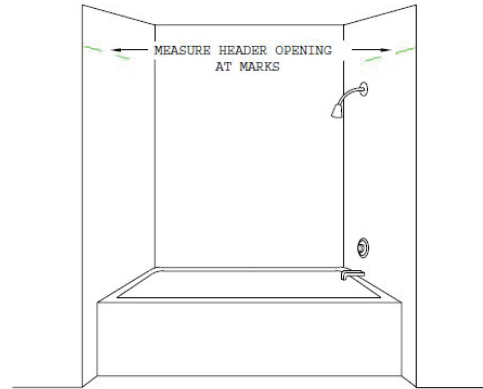

### STEP 5:

Slide Wall Jamba (W) onto the plastic panel as shown. Soapy water or window cleaner will help the panel slide on the Wall Jamba receiver.

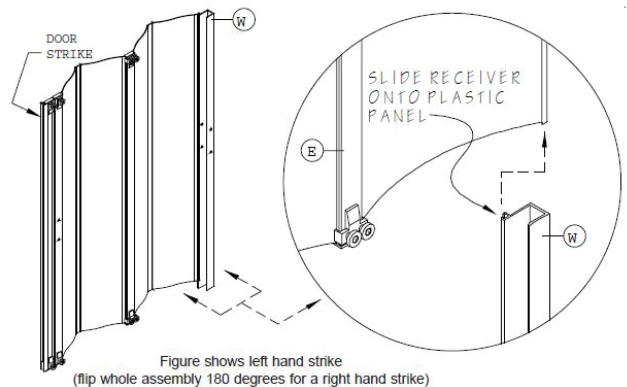

### STEP 6:

Insert door assembly rollers into Top and bottom Tracks (C&A). Ensure that rollers are properly engaged in tracks.

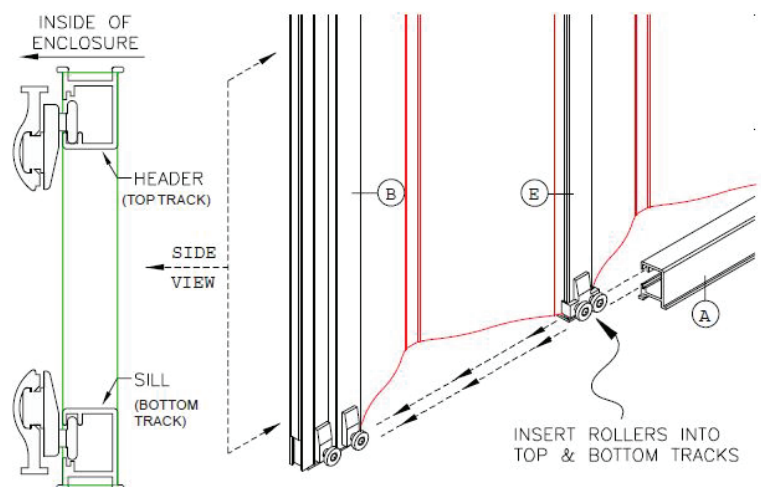

### STEP 7:

When satisfied that door assembly rollers are properly engaged with Top and Bottom Tracks, insert a Spring Nut (H) into both ends of Top and Bottom Tracks as shown.

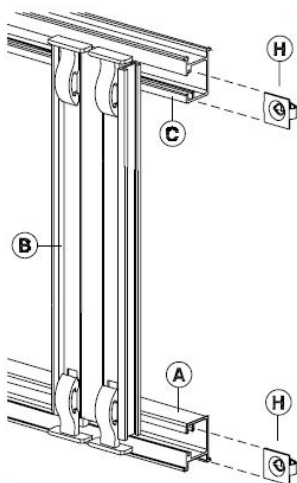

### STEP 8:

Secure ends of Top and Bottom Tracks to Wall Jambs (D&W) using Frame Assembly Screws (G) and Spring Nuts (H). (Spring Nuts were previously installed in Step 7). With Magnet Strip on each side of the door, check the Magnet on the door and the Magnet on the Wall Jamb make full and complete contact with each other. If there are gaps, loosen screw and add shim behind Wall Jamb as needed.

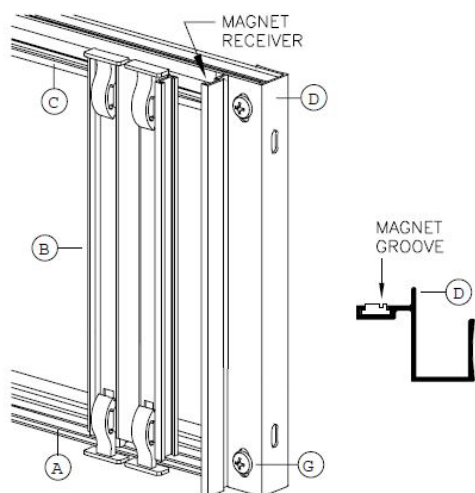

### STEP 9:

Lift the complete door assembly and set it on the tub or shower curb. Figure shows door striking on left side; your configuration may be different. Align the Wall Jamb installation holes with the Plastic Screw Anchors (F) installed in Step 3. Secure Wall Jambs to walls using eight (8) Assembly Screws (see exploded view - sht 1).

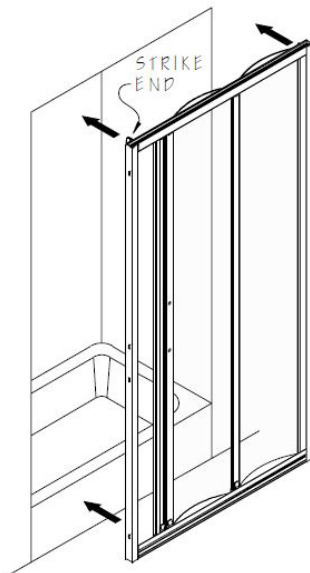

### STEP 10:

Using figures below as guides, install your Door Handle set (P) and the Door Latch (Q) as dictated by your shower door condition (left or right strike). For clarity purposes, figures below are shown with panels removed.

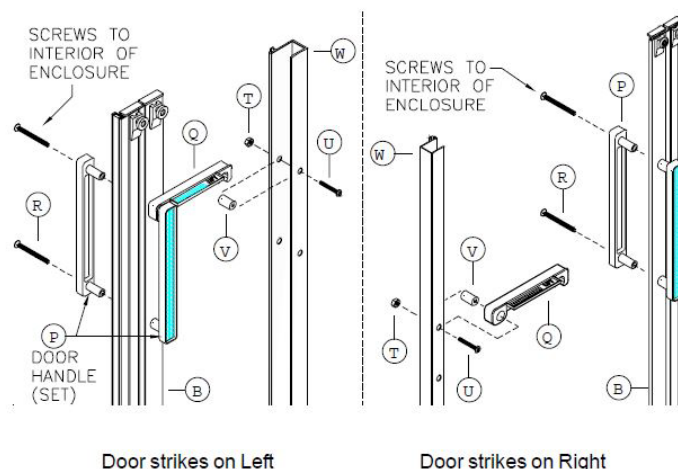

### STEP 11:

To ensure a leak proof installation, caulk either exterior or interior of unit as shown in figure below and at crevices indicated. Use a clear silicone or rubber sealant.

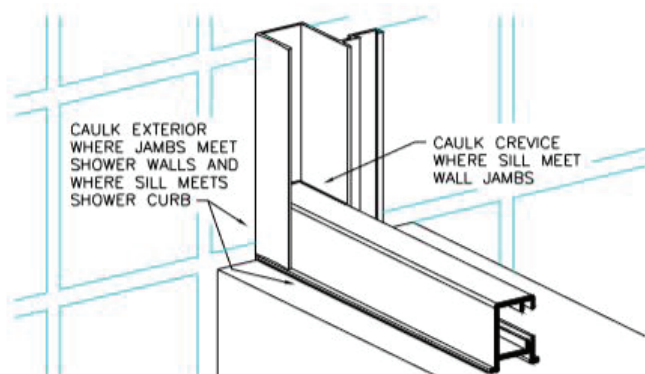

### STEP 12:

Latch the door completely open. Tape the bottom track to tub in center. Allow 24 hours for sealant to dry before using shower.

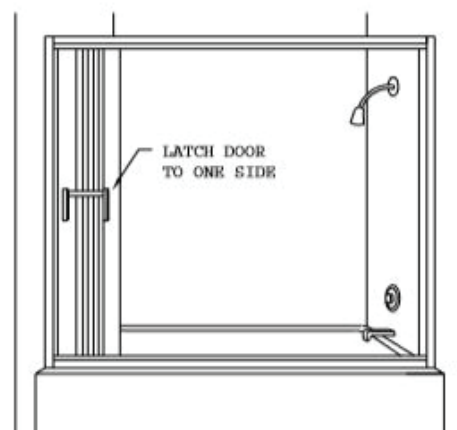

Key Letter	Part Number	Description	Quantity
A	117	Bottom Track (length varies)	1
B	*109	Lead Post (length varies)	2
C	117	Top Track (length varies)	1
D	112	Wall Jamb w/ Magnetic Strike (length varies)	2
E	*113	Panel Stiffeners/ Hinges	1-2
F	1329	Plastic Wall Anchors	8
G	1420PHP	Frame Assembly Screw	4
H	SN1	Frame Assembly Spring Nut	4
I	834P	Wall Jamb Mounting Screw	8
K	*Single R	Single Roller Bracket Assembly	4
L	*Double R	Double Roller Bracket Assembly	2 or 4
M	*GRC1	Glide Retainer Clip	6 or 8
N	*GS1	Glide Spring	6 or 8
O	SP(9",12")/HP(9",10.5")	Folding Panels (length varies)	2-3
P	PRT53	Door Handle (set)	1
Q	PRT54-#	Door Latch [# = number of panels (2,3)]	1
R	8134F	Door Handle Assembly Screws	4
S	*98-41	Magnetic Strips (pre-installed)	4
T	632N	Latch Spacer Hex Nut	1
U	632PHP	Latch Spacer Screw	1
V	SP182	Spacer	1
W	110	Wall Jamb w/ Panel Receiver	1

\*Parts preassembled in folding door assembly.

### Tools Needed

Level  
 Caulk  
 Hacksaw  
 Tape Measure  
 Masking Tape  
 Electric Drill  
 1/4" Drill Bit  
 Phillips Head Screw Driver  
 Petroleum Jelly or  
 Silicone Grease

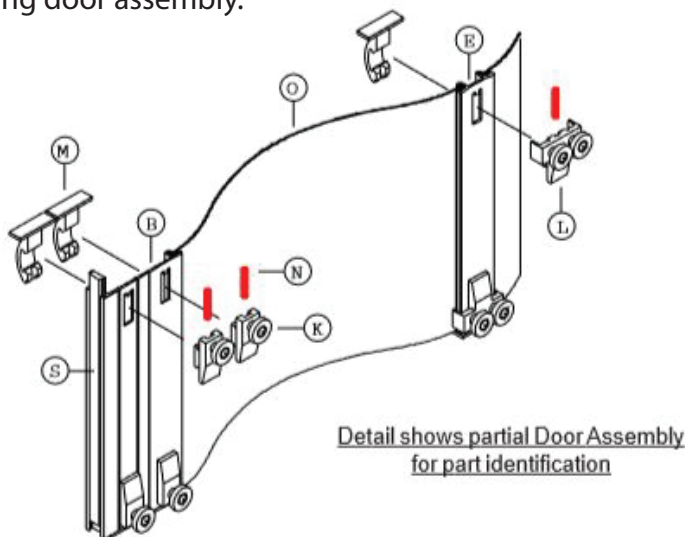

### Shower Door Maintenance

Shower Solutions USA shower doors should be rinsed and wiped off immediately after cleaning. Use cleaning agents compatible with product material. The aluminum frame and hinges are made from anodized aluminum; the panels are made from either PVC or polypropylene. Use cleaning products safe for plastics.

***Use of inappropriate cleaners will void warranty.***

### Shower Door Warranty

Shower Solutions USA shower doors have a one (1) year warranty from date of delivery. The end user must notify Shower Solutions USA within 3 months of delivery if box was damaged during shipping or if any part(s) were broken/missing during shipping. The shower doors are warranted to be free from defects in material and workmanship. Replacement is limited to supplying part(s) and does not include cost of shipping, installation, or other associated costs.

Please save this packet for future reference.