

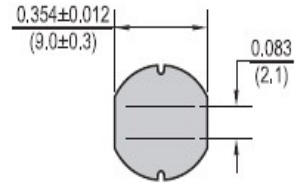

# Power Flat Shielded Inductor PF1004

Dimensions:  $\frac{\text{Inches}}{\text{(mm)}}$

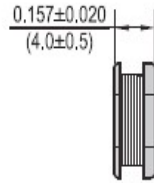
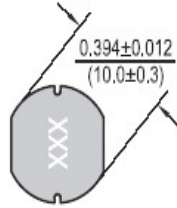
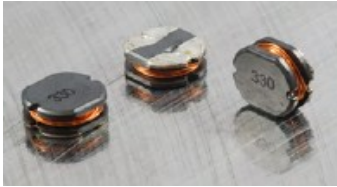

Wilco Part Number	Inductance (uh)	Tolerannce (%)	Test Freq.	DCR	IDC
				Max	(mAmps)
PF1004-1R0M-LF	1.0	20	100 KHz 1V	0.009	6000
PF1004-3R8M-LF	3.8	20	7.96 MHz 1V	0.02	4200
PF1004-100M-LF	10	20	2.52 MHz 1V	0.05	2380
PF1004-120M-LF	12	20	2.52 MHz 1V	0.06	2130
PF1004-150M-LF	15	20	2.52 MHz 1V	0.07	1870
PF1004-180M-LF	18	20	2.52 MHz 1V	0.08	1730
PF1004-220M-LF	22	20	2.52 MHz 1V	0.09	1600
PF1004-270M-LF	27	20	2.52 MHz 1V	0.10	1440
PF1004-330K-LF	33	10	2.52 MHz 1V	0.12	1260
PF1004-390K-LF	39	10	2.52 MHz 1V	0.15	1200
PF1004-470K-LF	47	10	2.52 MHz 1V	0.17	1100
PF1004-680K-LF	68	10	2.52 MHz 1V	0.22	910
PF1004-820K-LF	82	10	2.52 MHz 1V	0.30	850
PF1004-101K-LF	100	10	1KHz 1V	0.34	740
PF1004-121K-LF	120	10	1KHz 1V	0.40	690
PF1004-151K-LF	150	10	1KHz 1V	0.54	610
PF1004-181K-LF	180	10	1KHz 1V	0.62	560
PF1004-221K-LF	220	10	1KHz 1V	0.72	530
PF1004-271K-LF	270	10	1KHz 1V	0.95	450
PF1004-331K-LF	330	10	1KHz 1V	1.1	420
PF1004-391K-LF	390	10	1KHz 1V	1.24	380
PF1004-471K-LF	470	10	1KHz 1V	1.53	350
PF1004-561K-LF	560	10	1KHz 1V	1.9	320

**Features:** Unshielded, low cost design, high current applications, Excellent for DC-DC converter applications,

**Physical:** packaging 700 pieces per 13 inch reel marking EIA inductance code

**Electrical:** operating temp. -40C to 85C rated current inductance drop 10% typical

**Resistance to Soldering Heat:** pre-heat 150C 1 min solder temp. 260C +/- 5C immersion time 10 sec +/- 1 sec solder composition Sn/Ag3.0/Cu0.5

Wilco Corporation 5352 West 79<sup>th</sup> Street Indianapolis IN 46268

800-611-2343 Fax 317-228-9340 [wilcosales@wilcocorp.com](mailto:wilcosales@wilcocorp.com)

[www.wilcocorp.com](http://www.wilcocorp.com)